

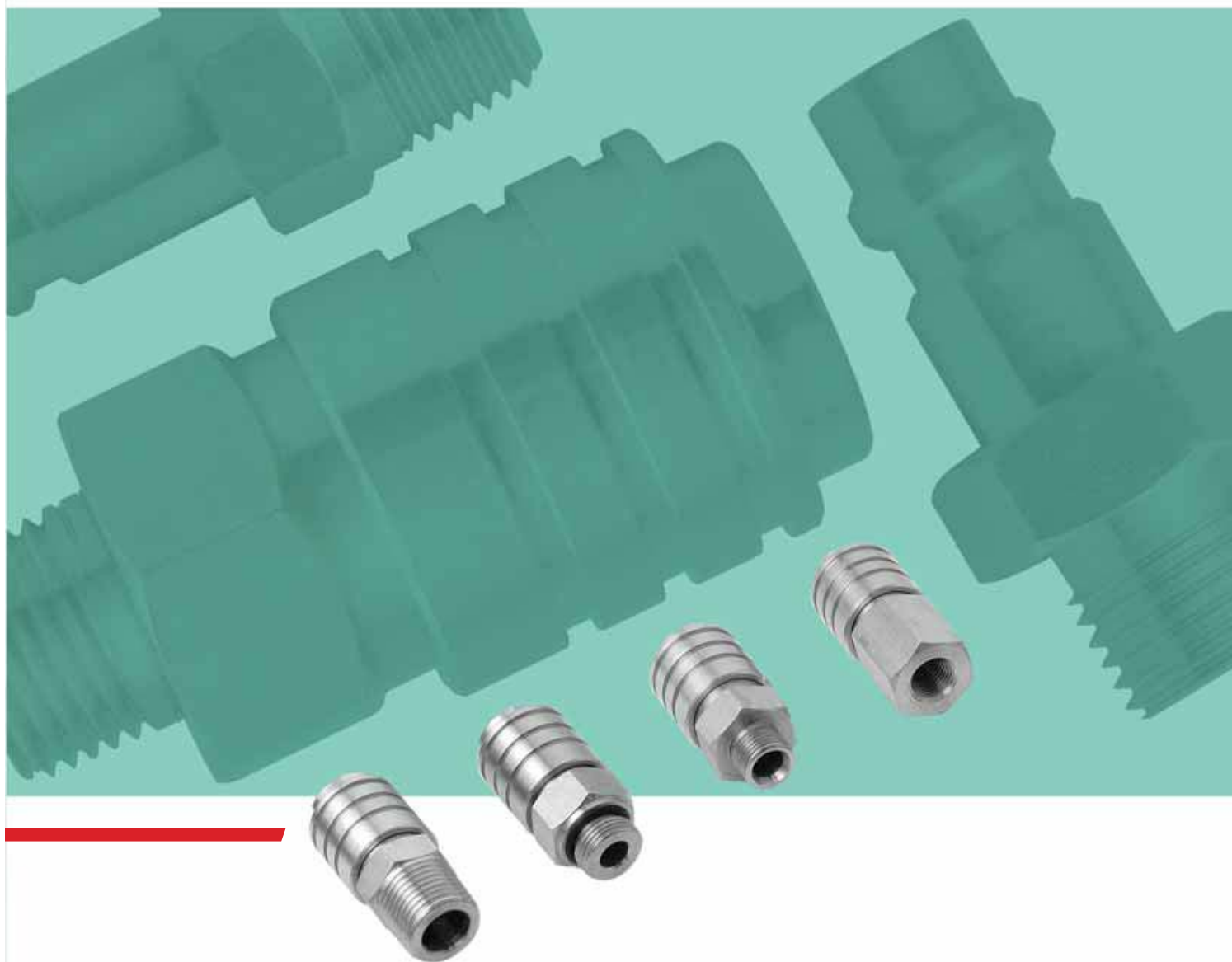

# Quick Connect Couplings



*Make the leak free connections with Sealexcel products at economical price.*



## ABOUT THE COMPANY



SEALEXCEL<sup>®</sup> (INDIA) PVT. LTD. is a fast growing manufacturing company in the field of design, development, production and marketing of high quality valves and fittings for International and domestic markets, since 1987.

### Product Range

- ♦ Twin Ferrule tube fittings
- ♦ Single Ferrule tube Fittings
- ♦ Tube fittings as per DIN 2353
- ♦ 37° Flared tube fittings
- ♦ Stainless Steel push in fittings
- ♦ Precision pipe fittings and Adaptors
- ♦ Stainless steel quick connect couplings
- ♦ Bar Stock and Forged body needle valves
- ♦ Instrumentation Ball Valves



### Our Focus

SEALEXCEL<sup>®</sup> manufactures all the above products to very stringent tolerances under rigid quality controlled procedures approved to ISO 9001:2000 quality management systems. The products are tested with continuous research and development programs to withstand the demand of high performance world class quality products for instrumentation and process tubing. These products are used in the environments like Oil, Gas, Chemical, Petrochemical, Nuclear, Power plant, Pharmaceutical, Hydraulic, Pneumatic, Marine, Packaging, Printing Industries etc.



### Manufacturing Facility

SEALEXCEL<sup>®</sup> has two well equipped manufacturing units in India having modern manufacturing facilities with CNC lathes, Single Spindle Auto Screw machines, Capsten lathes, Thread Rolling and many other machines to provide good quality products at economical prices.

### Product warranty

All the SEALEXCEL<sup>®</sup> products come with a warranty of 12 months from the date of shipment against any defect in material or workmanship. The warranty stands for replacement of determined defective parts only.

### Quality Policy

We at SEALEXCEL<sup>®</sup> not only strive to meet all of our customer's requirements but also enhance customer's expectation by providing them excellent products at economical price in time

This is achieved by

- ♦ Continuously improving the products, process and systems.
- ♦ Ensuring involvement of all the employees and enhancing their competency.
- ♦ Complying with all applicable statutory and regulatory Requirements.

### The Goal

SEALEXCEL<sup>®</sup> is committed to make every effort towards producing world class products at economical price.

SEALEXCEL® Stainless Steel Single Valve Quick Connect Couplings are resistance to aggressive environments and corrosive fluids etc and are generally used in many application across a wide sector of Industries such as

- Pneumatic Controls
- Air Supply to pneumatic machines
- Automatic devices
- Robotics
- Portable Equipment (Screw-driving & Drilling machines etc)
- Machines or equipment with a high air flow rate (Jacks, Pneumatics Wrenches, Compressors etc.)
- Laboratories (Medical, Pharmaceutical etc.)
- Coachwork, paint shops etc
- Instrumentation

## DESIGN

SEALEXCEL® Stainless Steel Single Valve Quick connect Couplings have been carefully designed and manufactured to very stringent tolerances under rigid quality control procedures approved to ISO 9001:2000 to provide zero leak connection.

## FEATURES

- Robust in construction
- Easy for manual connection and disconnection
- No tools required for connection and disconnection
- Reliable leak tight Sealing System
- Durable ball-locking mechanism assures reliable connection
- Valve guide positively aligns valve with seat to prevent leakage.
- Available with nominal flow passage size 5mm, 7.9mm, 10mm and 14mm.
- SEALEXCEL® Industrial interchange Plugs are interchangeable with similar Plugs manufactured by other quick coupling manufacturers confirming to ISO 6150 Series B and USMIL-C4109 or ANSI(NFPA) T3.20.14-1990 (R2004).
- Available as a standard in a SS316 construction with Flouorocarbon 'O' Ring.
- The Quick Connect coupling in material steel with Zinc plated are available on request.

## MATERIAL OF CONSTRUCTION

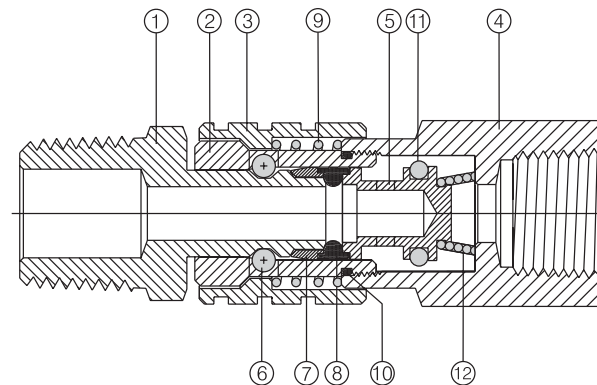

| Sr.No. | Part Name & Material     |
|--------|--------------------------|
| 1      | Plug, SS316              |
| 2      | Valve Body, SS316        |
| 3      | Locking Sleeve, SS316    |
| 4      | Adapter Plug, SS316      |
| 5      | Valve, SS316             |
| 6      | Locking Ball, SS         |
| 7      | Supporting Washer, SS316 |
| 8      | Seal Ring, Viton         |
| 9      | Spring, SS316            |
| 10     | 'O' Ring, Viton          |
| 11     | 'O' Ring, Viton          |
| 12     | Conical Spring, SS316    |

Note: The stainless steel 316 raw material meets the following specification:  
SS316 Bar stock-ASTM A-479 or equivalent.

## INSTALLATION PRINCIPLES



During Installation, the Plug part(1) pushes back the Valve (5) to open the air circuit.

When moving into the open position, the Valve releases the Locking balls (6) which move into the groove of the Plug.

Simultaneously the outer sleeve (3) moves forward, under spring load (9) and automatically locking the two parts i.e., Plug and Coupler.

Moving the outer sleeve back manually to disconnect, releases the balls which in turn allows the Plug to be withdrawn, permitting the Valve to move forward automatically closing the circuit.

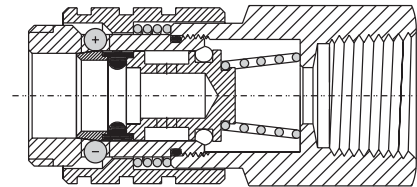

**DISCONNECTED POSITION**

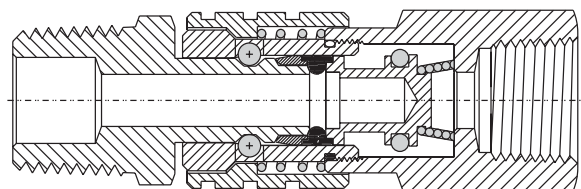

**CONNECTED POSITION**

### ORDERING INFORMATION :

The part number describes the complete Assembly of Quick connect Coupling without Plug.

**Example : CP50-4FN/EV**

| Cp50               | 4                   | FN             | E        | V        |
|--------------------|---------------------|----------------|----------|----------|
| Series of Coupling | Size of pipe thread | Type of thread | Material | 'O' Ring |
| 5mm Passage        | 1/4"                | Female NPT     | SS316    | Viton    |

### For Plugs

**Example : P50-4RT/E**

| P50             | 4                   | RT             | E        |
|-----------------|---------------------|----------------|----------|
| Series of Plugs | Size of pipe thread | Type of thread | Material |
| 5mm Passage     | 1/4"                | Male BSPT      | SS316    |

### Size Code description:

| Size | Code |
|------|------|
| 1/8  | 2    |
| 1/4  | 4    |
| 3/8  | 6    |
| 1/2  | 8    |
| 3/4  | 12   |
| M14  | M14  |

### Material Code description:

| Material | Code |
|----------|------|
| SS316    | E    |
| Steel    | S    |
| Viton    | V    |
| Buna     | N    |

### Thread Code description:

| Type of Thread          | Code |
|-------------------------|------|
| BSPT-Male               | RT   |
| BSPT-Female             | FRT  |
| BSP-Hose                | HC   |
| BSP-Elastomeric Sealing | EO   |
| Metric                  | M    |
| NPT-Male                | N    |
| NPT-Female              | FN   |
| BSP-Female              | FRG  |

### Series Code Description for Quick Connect Coupling

| Series | Passage | Series | Passage |
|--------|---------|--------|---------|
| CP50   | 5.0mm   | CP187  | 3/16"   |
| CP79   | 7.9mm   | CP281  | 9/32"   |
| CP100  | 10.0mm  | CP375  | 3/8"    |
| CP140  | 14.0mm  | CP562  | 9/16"   |

## SERIES CP50 QUICK CONNECT COUPLING

### Flow Passage - 5.0mm

Maximum Flow rate - 6 bar

Working Temperature : 180° C



#### Male ISO Tapered pipe thread

| N-Male<br>Pipe Thread | D    | L1   | L2   | A/F  | PART NO.  |
|-----------------------|------|------|------|------|-----------|
| 1/8" BSPT             | 22.0 | 54.5 | 9.0  | 17.4 | CP50-2RT  |
| 1/4" BSPT             | 22.0 | 58.5 | 12.5 | 17.4 | CP50-4RT  |
| M14 x 1.25            | 22.0 | 58.5 | 12.5 | 17.4 | CP50-M14M |

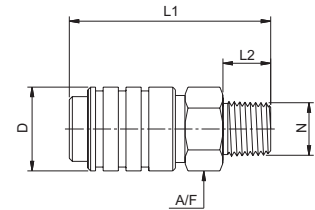

#### Male Parallel pipe thread and 60° sealing cone for connection to hose pipes fitted with sealing cone & swivel nut.

| P-Male<br>Pipe Thread | D    | L1   | L2   | A/F  | PART NO. |
|-----------------------|------|------|------|------|----------|
| 1/8" BSP              | 22.0 | 53.5 | 8.0  | 17.4 | CP50-2HC |
| 1/4" BSP              | 22.0 | 56.5 | 10.0 | 17.4 | CP50-4HC |

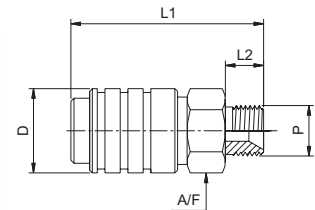

#### Male ISO Parallel pipe thread (BSP) with Elastomeric Sealing

| P-Male<br>Pipe Thread | D    | L1   | L2  | A/F  | PART NO. |
|-----------------------|------|------|-----|------|----------|
| 1/8" BSP              | 22.0 | 52.0 | 6.5 | 17.4 | CP50-2EO |
| 1/4" BSP              | 22.0 | 54.0 | 8.0 | 17.4 | CP50-4EO |

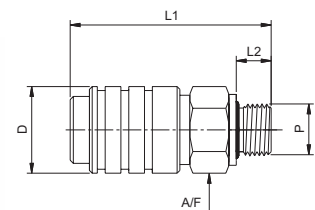

#### Female ISO Tapered pipe thread

| N-Female<br>Pipe Thread | D    | L1   | L2   | A/F  | PART NO.  |
|-------------------------|------|------|------|------|-----------|
| 1/8" BSPT               | 22.0 | 55.5 | 10.0 | 17.4 | CP50-2FRT |
| 1/4" BSPT               | 22.0 | 59.5 | 14.0 | 19.0 | CP50-4FRT |

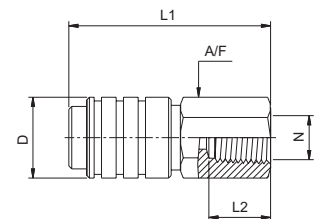

#### Female ISO parallel pipe thread

| P-Female<br>Pipe Thread | D    | L1   | L2   | A/F  | PART NO.  |
|-------------------------|------|------|------|------|-----------|
| 1/8" BSP                | 22.0 | 55.5 | 10.0 | 17.4 | CP50-2FRG |
| 1/4" BSP                | 22.0 | 59.5 | 14.0 | 19.0 | CP50-4FRG |
| M14 x 1.25              | 22.0 | 59.5 | 14.0 | 19.0 | CP50-M14F |

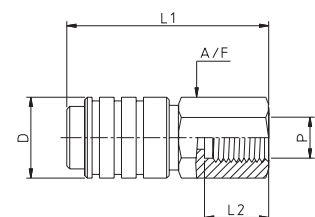

Dimensions are for reference only, and are subject to change without notice.



## SERIES CP79 QUICK CONNECT COUPLING

### Flow Passage 7.9mm

Maximum Flow rate - 6 bar

Working Temperature : 180° C



#### Male ISO Tapered pipe thread

| N-Male<br>Pipe Thread | D    | L1   | L2   | A/F  | PART NO. |
|-----------------------|------|------|------|------|----------|
| 1/4" BSPT             | 25.0 | 59.0 | 12.5 | 22.0 | CP79-4RT |
| 3/8" BSPT             | 25.0 | 59.0 | 12.5 | 22.0 | CP79-6RT |
| 1/2" BSPT             | 25.0 | 63.0 | 16.5 | 22.0 | CP79-8RT |

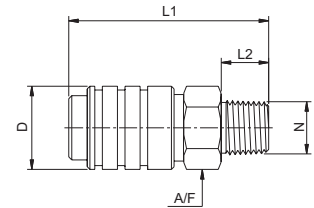

#### Male Parallel pipe thread and 60° sealing cone for connection to hose pipes fitted with sealing cone & swivel nut.

| P-Male<br>Pipe Thread | D    | L1   | L2   | A/F  | PART NO. |
|-----------------------|------|------|------|------|----------|
| 1/4" BSP              | 25.0 | 56.5 | 10.0 | 22.0 | CP79-4HC |
| 3/8" BSP              | 25.0 | 56.5 | 10.0 | 22.0 | CP79-6HC |
| 1/2" BSP              | 25.0 | 59.5 | 12.0 | 22.0 | CP79-8HC |

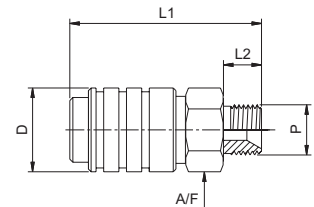

#### Male ISO Parallel pipe thread (BSP) with Elastomeric Sealing

| P-Male<br>Pipe Thread | D    | L1   | L2   | A/F  | PART NO. |
|-----------------------|------|------|------|------|----------|
| 1/4" BSP              | 25.0 | 54.5 | 8.0  | 22.0 | CP79-4EO |
| 3/8" BSP              | 25.0 | 54.5 | 8.0  | 22.0 | CP79-6EO |
| 1/2" BSP              | 25.0 | 58.0 | 10.5 | 27.0 | CP79-8EO |

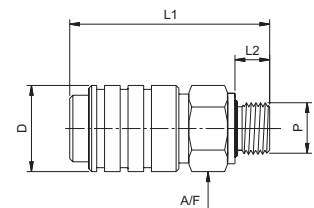

#### Female ISO Tapered pipe thread

| N-Female<br>Pipe Thread | D    | L1   | L2   | A/F  | PART NO.  |
|-------------------------|------|------|------|------|-----------|
| 1/4" BSPT               | 25.0 | 60.0 | 14.0 | 22.0 | CP79-4FRT |
| 3/8" BSPT               | 25.0 | 60.0 | 14.0 | 22.0 | CP79-6FRT |
| 1/2" BSPT               | 25.0 | 64.0 | 18.0 | 27.0 | CP79-8FRT |

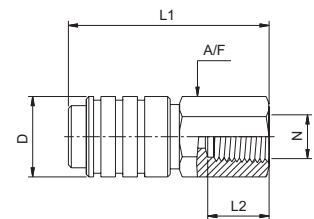

#### Female ISO parallel pipe thread

| P-Female<br>Pipe Thread | D    | L1   | L2   | A/F  | PART NO.  |
|-------------------------|------|------|------|------|-----------|
| 1/4" BSP                | 25.0 | 60.0 | 14.0 | 22.0 | CP79-4FRG |
| 3/8" BSP                | 25.0 | 60.0 | 14.0 | 22.0 | CP79-6FRG |
| 1/2" BSP                | 25.0 | 64.0 | 18.0 | 27.0 | CP79-8FRG |

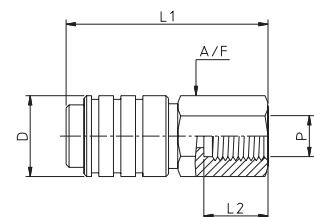

Dimensions are for reference only, and are subject to change without notice.

## SERIES CP100 QUICK CONNECT COUPLING

### Flow Passage 10.0mm

Maximum Flow rate 6 bar

Working Temperature : 180° C



#### Male ISO Tapered pipe thread

| N-Male<br>Pipe Thread | D    | L1   | L2   | A/F  | PART NO.  |
|-----------------------|------|------|------|------|-----------|
| 3/8" BSPT             | 34.0 | 76.0 | 14.3 | 27.0 | CP100-6RT |
| 1/2" BSPT             | 34.0 | 82.0 | 19.0 | 27.0 | CP100-8RT |

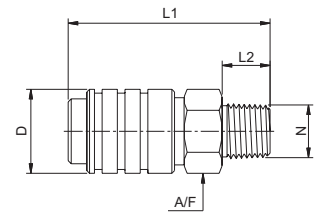

#### Male Parallel pipe thread and 60° sealing cone for connection to hose pipes fitted with sealing cone & swivel nut.

| P-Male<br>Pipe Thread | D    | L1   | L2   | A/F  | PART NO.  |
|-----------------------|------|------|------|------|-----------|
| 1/2" BSP              | 34.0 | 77.0 | 14.0 | 27.0 | CP100-8HC |

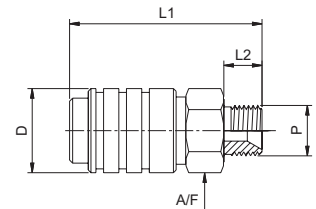

#### Male ISO Parallel pipe thread (BSP) with Elastomeric Sealing

| P-Male<br>Pipe Thread | D    | L1   | L2   | A/F  | PART NO.  |
|-----------------------|------|------|------|------|-----------|
| 3/8" BSP              | 34.0 | 73.0 | 10.0 | 27.0 | CP100-6EO |
| 1/2" BSP              | 34.0 | 75.0 | 12.0 | 27.0 | CP100-8EO |

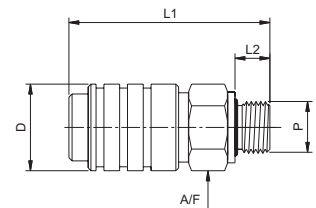

#### Female ISO Tapered pipe thread

| N-Female<br>Pipe Thread | D    | L1   | L2   | A/F  | PART NO.   |
|-------------------------|------|------|------|------|------------|
| 3/8" BSPT               | 34.0 | 78.0 | 15.0 | 27.0 | CP100-6FRT |
| 1/2" BSPT               | 34.0 | 83.0 | 20.0 | 27.0 | CP100-8FRT |

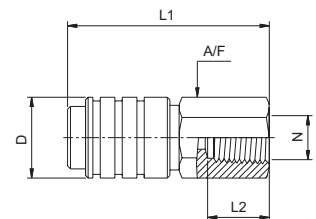

#### Female ISO parallel pipe thread

| P-Female<br>Pipe Thread | D    | L1   | L2   | A/F  | PART NO.   |
|-------------------------|------|------|------|------|------------|
| 3/8" BSP                | 34.0 | 78.0 | 15.0 | 27.0 | CP100-6FRG |
| 1/2" BSP                | 34.0 | 83.0 | 20.0 | 27.0 | CP100-8FRG |

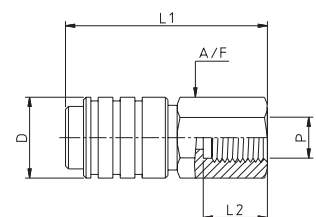

Dimensions are for reference only, and are subject to change without notice.

## SERIES CP140 QUICK CONNECT COUPLING

### Flow Passage 14.0mm

Maximum Flow rate 6 bar  
Working Temperature : 180° C



#### Male ISO Tapered pipe thread

| N-Male<br>Pipe Thread | D    | L1   | L2   | A/F  | PART NO.   |
|-----------------------|------|------|------|------|------------|
| 1/2" BSPT             | 40.0 | 82.0 | 19.0 | 27.0 | CP140-8RT  |
| 3/4" BSPT             | 40.0 | 82.0 | 19.0 | 28.5 | CP140-12RT |

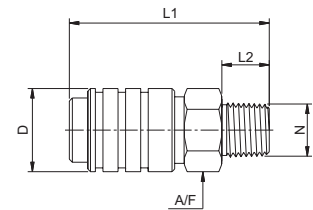

#### Male Parallel pipe thread and 60° sealing cone for connection to hose pipes fitted with sealing cone & swivel nut.

| P-Male<br>Pipe Thread | D    | L1   | L2   | A/F  | PART NO.   |
|-----------------------|------|------|------|------|------------|
| 1/2" BSP              | 40.0 | 77.0 | 14.0 | 35.0 | CP140-8HC  |
| 3/4" BSP              | 40.0 | 77.0 | 14.0 | 35.0 | CP140-12HC |

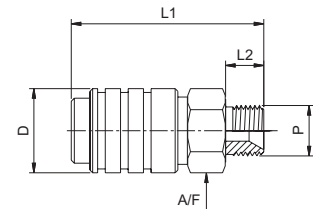

#### Male ISO Parallel pipe thread (BSP) with Elastomeric Sealing

| P-Male<br>Pipe Thread | D    | L1   | L2   | A/F  | PART NO.   |
|-----------------------|------|------|------|------|------------|
| 1/2" BSP              | 40.0 | 75.0 | 12.0 | 35.0 | CP140-8EO  |
| 3/4" BSP              | 40.0 | 75.0 | 12.0 | 35.0 | CP140-12EO |

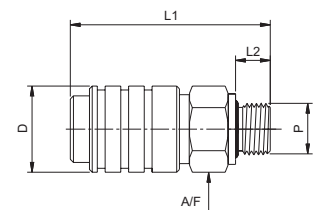

#### Female ISO Tapered pipe thread

| N-Female<br>Pipe Thread | D    | L1   | L2   | A/F  | PART NO.    |
|-------------------------|------|------|------|------|-------------|
| 1/2" BSPT               | 40.0 | 83.0 | 20.0 | 35.0 | CP140-8FRT  |
| 3/4" BSPT               | 40.0 | 83.0 | 20.0 | 35.0 | CP140-12FRT |

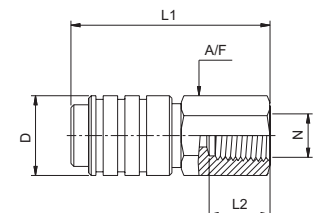

#### Female ISO parallel pipe thread

| P-Female<br>Pipe Thread | D    | L1   | L2   | A/F  | PART NO.    |
|-------------------------|------|------|------|------|-------------|
| 1/2" BSP                | 40.0 | 83.0 | 20.0 | 35.0 | CP140-8FRG  |
| 3/4" BSP                | 40.0 | 83.0 | 20.0 | 35.0 | CP140-12FRG |

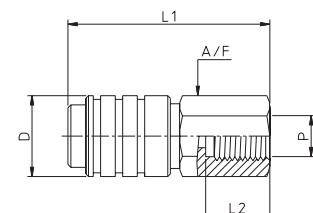

Dimensions are for reference only, and are subject to change without notice.



## SERIES P50 PLUGS

### Flow Passage 5.0mm



#### Male ISO Tapered pipe thread

| N-Male<br>Pipe Thread | D   | L1   | L2   | A/F  | PART NO. |
|-----------------------|-----|------|------|------|----------|
| 1/8" BSPT             | 5.0 | 38.5 | 9.0  | 14.3 | P50-2RT  |
| 1/4" BSPT             | 5.0 | 42.5 | 12.5 | 14.3 | P50-4RT  |
| 3/8" BSPT             | 5.0 | 42.5 | 12.5 | 17.4 | P50-6RT  |
| M14 x 1.25            | 5.0 | 42.5 | 12.5 | 17.4 | P50-M14M |

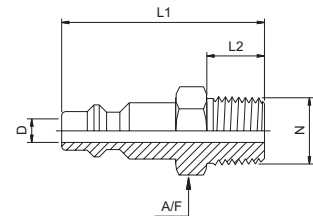

#### Male Parallel pipe thread and 60° sealing cone for connection to hose pipes fitted with sealing cone & swivel nut.

| P-Male<br>Pipe Thread | D   | L1   | L2   | A/F  | PART NO. |
|-----------------------|-----|------|------|------|----------|
| 1/8" BSP              | 5.0 | 38.0 | 8.0  | 14.3 | P50-2HC  |
| 1/4" BSP              | 5.0 | 40.0 | 10.0 | 17.4 | P50-4HC  |
| 3/8" BSP              | 5.0 | 40.0 | 10.0 | 17.4 | P50-6HC  |

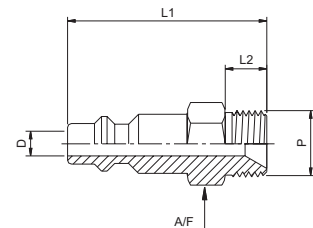

#### Male ISO Parallel pipe thread (BSP) with Elastomeric Sealing

| P-Male<br>Pipe Thread | D   | L1   | L2  | A/F  | PART NO. |
|-----------------------|-----|------|-----|------|----------|
| 1/8" BSP              | 5.0 | 38.0 | 6.5 | 14.3 | P50-2EO  |
| 1/4" BSP              | 5.0 | 39.5 | 8.0 | 17.4 | P50-4EO  |
| 3/8" BSP              | 5.0 | 41.0 | 8.0 | 22.0 | P50-6EO  |

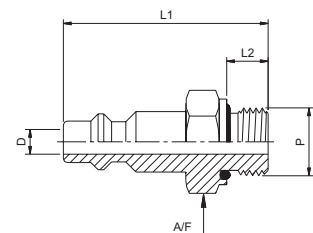

#### Female ISO Tapered pipe thread

| N-Female<br>Pipe Thread | D   | L1   | L2   | A/F  | PART NO. |
|-------------------------|-----|------|------|------|----------|
| 1/8" BSPT               | 5.0 | 36.6 | 10.0 | 14.3 | P50-2FRT |
| 1/4" BSPT               | 5.0 | 40.6 | 14.0 | 19.0 | P50-4FRT |
| 3/8" BSPT               | 5.0 | 40.6 | 14.0 | 22.0 | P50-6FRT |
| M14 x 1.25              | 5.0 | 40.6 | 14.0 | 19.0 | P50-M14F |

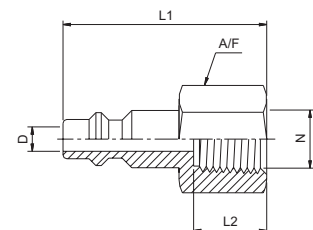

#### Male Barb End Plug

| P-Barb<br>End | D   | L1   | L2   | A/F  | PART NO. |
|---------------|-----|------|------|------|----------|
| 8mm           | 5.0 | 52.0 | 22.0 | 14.0 | P50-8BC  |
| 10mm          | 5.0 | 52.0 | 22.0 | 14.0 | P50-10BC |

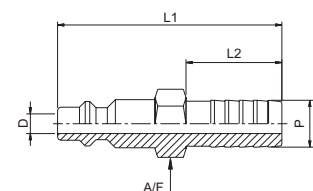

Dimensions are for reference only, and are subject to change without notice.

## SERIES P79 PLUGS

### Flow Passage 7.9mm



#### Male ISO Tapered pipe thread

| N-Male<br>Pipe Thread | D   | L1   | L2   | A/F  | PART NO. |
|-----------------------|-----|------|------|------|----------|
| 1/4" BSPT             | 7.9 | 45.0 | 12.5 | 17.4 | P79-4RT  |
| 3/8" BSPT             | 7.9 | 45.0 | 12.5 | 17.4 | P79-6RT  |
| 1/2" BSPT             | 7.9 | 51.0 | 17.0 | 22.0 | P79-8RT  |

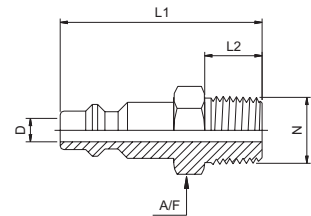

#### Male Parallel pipe thread and 60° sealing cone for connection to hose pipes fitted with sealing cone & swivel nut.

| P-Male<br>Pipe Thread | D   | L1   | L2   | A/F  | PART NO. |
|-----------------------|-----|------|------|------|----------|
| 1/4" BSP              | 7.9 | 43.5 | 11.0 | 17.4 | P79-4HC  |
| 3/8" BSP              | 7.9 | 43.5 | 11.0 | 17.4 | P79-6HC  |
| 1/2" BSP              | 7.9 | 48.5 | 14.0 | 22.0 | P79-8HC  |

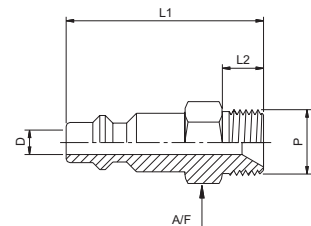

#### Male ISO Parallel pipe thread (BSP) with Elastomeric Sealing

| P-Male<br>Pipe Thread | D   | L1   | L2   | A/F  | PART NO. |
|-----------------------|-----|------|------|------|----------|
| 1/4" BSP              | 7.9 | 42.0 | 8.0  | 17.4 | P79-4EO  |
| 3/8" BSP              | 7.9 | 42.0 | 8.0  | 20.5 | P79-6EO  |
| 1/2" BSP              | 7.9 | 45.5 | 10.0 | 27.0 | P79-8EO  |

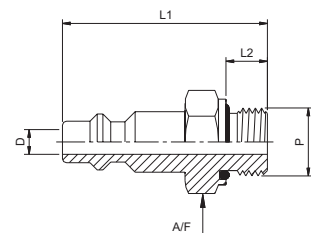

#### Female ISO Tapered pipe thread

| N-Female<br>Pipe Thread | D   | L1   | L2   | A/F  | PART NO. |
|-------------------------|-----|------|------|------|----------|
| 1/4" BSPT               | 7.9 | 43.0 | 14.0 | 19.0 | P79-4FRT |
| 3/8" BSPT               | 7.9 | 43.0 | 14.0 | 22.0 | P79-6FRT |
| 1/2" BSPT               | 7.9 | 47.0 | 18.0 | 27.0 | P79-8FRT |

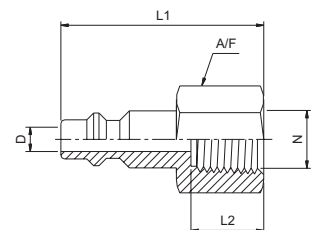

#### Male Barb End Plug

| P-Barb<br>End | D   | L1   | L2   | A/F  | PART NO. |
|---------------|-----|------|------|------|----------|
| 10mm          | 7.9 | 58.5 | 26.0 | 16.0 | P79-10BC |
| 12mm          | 7.9 | 62.5 | 30.0 | 16.0 | P79-12BC |

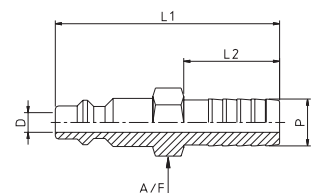

Dimensions are for reference only, and are subject to change without notice.

## SERIES P100 PLUGS

### Flow Passage 10.0mm



#### Male ISO Tapered pipe thread

| N-Male<br>Pipe Thread | D    | L1   | L2   | A/F  | PART NO. |
|-----------------------|------|------|------|------|----------|
| 3/8" BSPT             | 10.0 | 53.7 | 12.5 | 19.0 | P100-6RT |
| 1/2" BSPT             | 10.0 | 59.8 | 17.0 | 22.0 | P100-8RT |

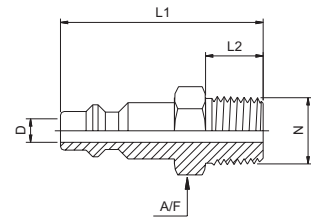

#### Male Parallel pipe thread and 60° sealing cone for connection to hose pipes fitted with sealing cone & swivel nut.

| P-Male<br>Pipe Thread | D    | L1   | L2   | A/F  | PART NO. |
|-----------------------|------|------|------|------|----------|
| 3/8" BSP              | 10.0 | 52.2 | 11.0 | 19.0 | P100-6HC |
| 1/2" BSP              | 10.0 | 56.8 | 14.0 | 22.0 | P100-8HC |

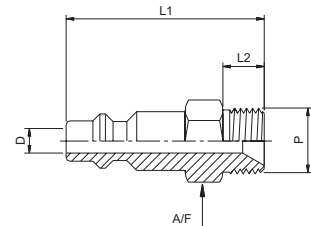

#### Male ISO Parallel pipe thread (BSP) with Elastomeric Sealing

| P-Male<br>Pipe Thread | D    | L1   | L2   | A/F  | PART NO. |
|-----------------------|------|------|------|------|----------|
| 3/8" BSP              | 10.0 | 52.2 | 8.0  | 20.5 | P100-6EO |
| 1/2" BSP              | 10.0 | 54.4 | 10.0 | 27.0 | P100-8EO |

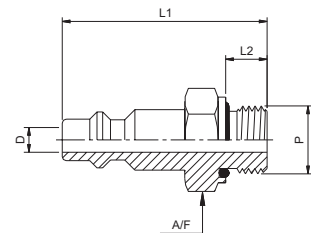

#### Female ISO Tapered pipe thread

| N-Female<br>Pipe Thread | D    | L1   | L2   | A/F  | PART NO.  |
|-------------------------|------|------|------|------|-----------|
| 3/8" BSPT               | 10.0 | 52.0 | 14.0 | 22.0 | P100-6FRT |
| 1/2" BSPT               | 10.0 | 56.0 | 18.0 | 27.0 | P100-8FRT |

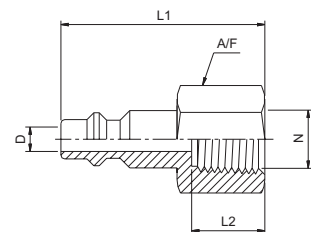

#### Male Barb End Plug

| P-Barb<br>End | D    | L1   | L2   | A/F  | PART NO.  |
|---------------|------|------|------|------|-----------|
| 12mm          | 10.0 | 62.5 | 30.0 | 19.0 | P100-12BC |
| 14mm          | 10.0 | 62.5 | 30.0 | 19.0 | P100-14BC |
| 16mm          | 10.0 | 62.5 | 30.0 | 19.0 | P100-16BC |

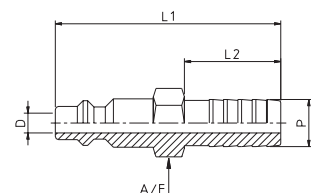

Dimensions are for reference only, and are subject to change without notice.

## SERIES P140 PLUGS

### Flow Passage 14.0mm



#### Male ISO Tapered pipe thread

| N-Male<br>Pipe Thread | D    | L1   | L2   | A/F  | PART NO.  |
|-----------------------|------|------|------|------|-----------|
| 1/2" BSPT             | 14.0 | 59.8 | 17.0 | 25.4 | P140-8RT  |
| 3/4" BSPT             | 14.0 | 59.8 | 17.0 | 28.5 | P140-12RT |

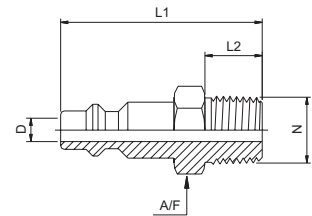

#### Male Parallel pipe thread and 60° sealing cone for connection to hose pipes fitted with sealing cone & swivel nut.

| P-Male<br>Pipe Thread | D    | L1   | L2   | A/F  | PART NO.  |
|-----------------------|------|------|------|------|-----------|
| 1/2" BSP              | 14.0 | 56.8 | 14.0 | 25.4 | P140-8HC  |
| 3/4" BSP              | 14.0 | 56.8 | 14.0 | 28.5 | P140-12HC |

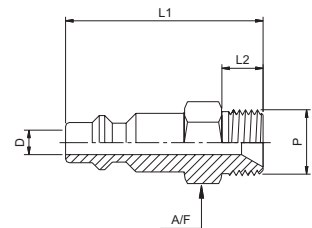

#### Male ISO Parallel pipe thread (BSP) with Elastomeric Sealing

| P-Male<br>Pipe Thread | D    | L1   | L2   | A/F  | PART NO.  |
|-----------------------|------|------|------|------|-----------|
| 1/2" BSP              | 14.0 | 54.4 | 10.0 | 27.0 | P140-8EO  |
| 3/4" BSP              | 14.0 | 56.4 | 12.0 | 32.0 | P140-12EO |

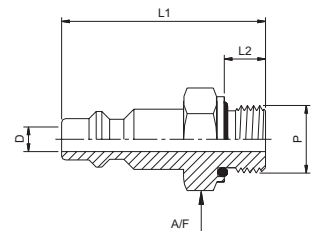

#### Female ISO Tapered pipe thread

| N-Female<br>Pipe Thread | D    | L1   | L2   | A/F  | PART NO.   |
|-------------------------|------|------|------|------|------------|
| 3/8" BSPT               | 14.0 | 52.0 | 14.0 | 25.4 | P140-6FRT  |
| 1/2" BSPT               | 14.0 | 56.0 | 18.0 | 27.0 | P140-8FRT  |
| 3/4" BSPT               | 14.0 | 56.0 | 18.0 | 32.0 | P140-12FRT |

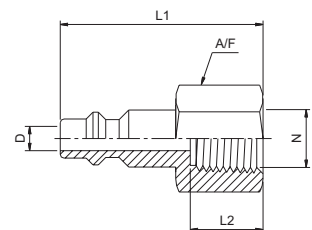

#### Male Barb End Plug

| P-Barb<br>End | D    | L1   | L2   | A/F  | PART NO.  |
|---------------|------|------|------|------|-----------|
| 16mm          | 14.0 | 77.8 | 35.0 | 25.4 | P140-16BC |

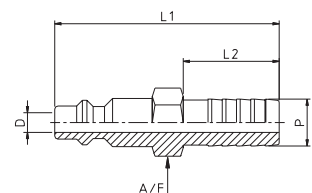

Dimensions are for reference only, and are subject to change without notice.

## SERIES CP187 QUICK CONNECT COUPLING

### Flow Passage 3/16"

Maximum Flow rate 6 bar

Working Temperature : 180° C



#### Male NPT pipe thread

| N-Male<br>Pipe Thread | D      | L1     | L2     | A/F    | PART NO. |
|-----------------------|--------|--------|--------|--------|----------|
| 1/8" NPT              | 0.875" | 2.125" | 0.375" | 11/16" | CP187-2N |
| 1/4" NPT              | 0.875" | 2.250" | 0.500" | 11/16" | CP187-4N |

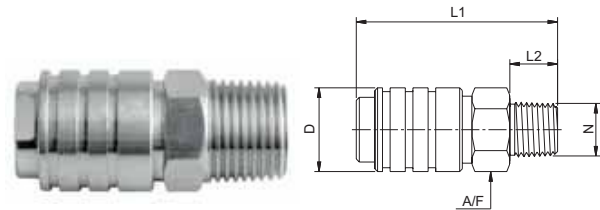

#### Female NPT pipe thread

| N-Female<br>Pipe Thread | D      | L1     | L2     | A/F    | PART NO.  |
|-------------------------|--------|--------|--------|--------|-----------|
| 1/8" NPT                | 0.875" | 2.250" | 0.437" | 11/16" | CP187-2FN |
| 1/4" NPT                | 0.875" | 2.375" | 0.562" | 3/4"   | CP187-4FN |

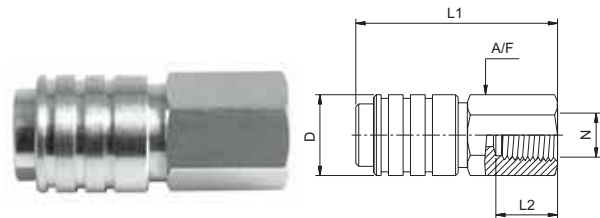

## SERIES CP281 QUICK CONNECT COUPLING

### Flow Passage 9/32"

Maximum Flow rate 6 bar

Working Temperature : 180° C

#### Male NPT pipe thread

| N-Male<br>Pipe Thread | D      | L1     | L2     | A/F  | PART NO. |
|-----------------------|--------|--------|--------|------|----------|
| 1/4" NPT              | 1.000" | 2.375" | 0.500" | 7/8" | CP281-4N |
| 3/8" NPT              | 1.000" | 2.375" | 0.500" | 7/8" | CP281-6N |
| 1/2" NPT              | 1.000" | 2.500" | 0.650" | 7/8" | CP281-8N |

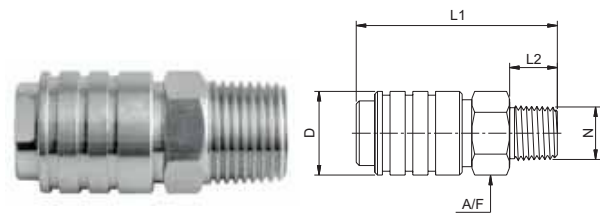

#### Female NPT pipe thread

| N-Female<br>Pipe Thread | D      | L1     | L2     | A/F     | PART NO.  |
|-------------------------|--------|--------|--------|---------|-----------|
| 1/4" NPT                | 1.000" | 2.375" | 0.562" | 7/8"    | CP281-4FN |
| 3/8" NPT                | 1.000" | 2.375" | 0.562" | 7/8"    | CP281-6FN |
| 1/2" NPT                | 1.000" | 2.500" | 0.750" | 1-1/16" | CP281-8FN |

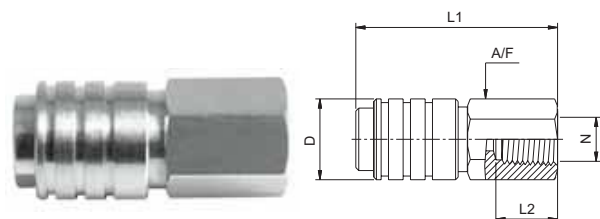

Dimensions are for reference only, and are subject to change without notice.



## SERIES CP375 QUICK CONNECT COUPLING

### Flow Passage 3/8"

Maximum Flow rate 6 bar

Working Temperature : 180° C



#### Male NPT pipe thread

| N-Male<br>Pipe Thread | D      | L1     | L2     | A/F     | PART NO. |
|-----------------------|--------|--------|--------|---------|----------|
| 3/8" NPT              | 1.340" | 3.000" | 0.562" | 1-1/16" | CP375-6N |
| 1/2" NPT              | 1.340" | 3.187" | 0.750" | 1-1/16" | CP375-8N |

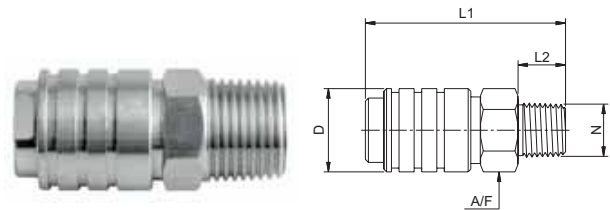

#### Female NPT pipe thread

| N-Female<br>Pipe Thread | D      | L1     | L2     | A/F     | PART NO.  |
|-------------------------|--------|--------|--------|---------|-----------|
| 3/8" NPT                | 1.340" | 3.062" | 0.625" | 1-1/16" | CP375-6FN |
| 1/2" NPT                | 1.340" | 3.250" | 0.810" | 1-1/16" | CP375-8FN |

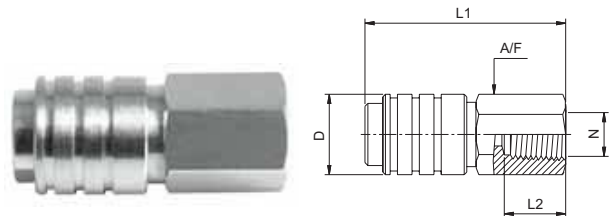

## SERIES CP562 QUICK CONNECT COUPLING

### Flow Passage 9/16"

Maximum Flow rate 6 bar

Working Temperature : 180° C

#### Male NPT pipe thread

| N-Male<br>Pipe Thread | D      | L1     | L2     | A/F    | PART NO.  |
|-----------------------|--------|--------|--------|--------|-----------|
| 1/2" NPT              | 1.575" | 3.250" | 0.750" | 1-3/8" | CP562-8N  |
| 3/4" NPT              | 1.575" | 3.250" | 0.750" | 1-3/8" | CP562-12N |

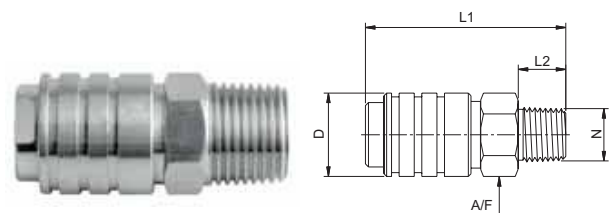

#### Female NPT pipe thread

| N-Female<br>Pipe Thread | D      | L1     | L2     | A/F    | PART NO.   |
|-------------------------|--------|--------|--------|--------|------------|
| 1/2" NPT                | 1.575" | 3.250" | 0.810" | 1-3/8" | CP562-8FN  |
| 3/4" NPT                | 1.575" | 3.250" | 0.810" | 1-3/8" | CP562-12FN |

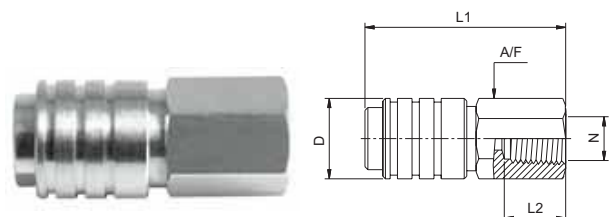

Dimensions are for reference only, and are subject to change without notice.

## SERIES P187 PLUGS

### Flow Passage 3/16"



#### Male NPT pipe thread

| N-Male<br>Pipe Thread | D     | L1     | L2     | A/F    | PART NO. |
|-----------------------|-------|--------|--------|--------|----------|
| 1/8" NPT              | 3/16" | 1.500" | 0.375" | 9/16"  | P187-2N  |
| 1/4" NPT              | 3/16" | 1.625" | 0.500" | 9/16"  | P187-4N  |
| 3/8" NPT              | 3/16" | 1.625" | 0.500" | 11/16" | P187-6N  |

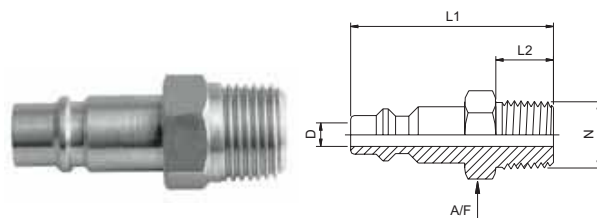

#### Female NPT pipe thread

| N-Female<br>Pipe Thread | D     | L1     | L2     | A/F   | PART NO. |
|-------------------------|-------|--------|--------|-------|----------|
| 1/8" NPT                | 3/16" | 1.437" | 0.437" | 9/16" | P187-2FN |
| 1/4" NPT                | 3/16" | 1.625" | 0.562" | 3/4"  | P187-4FN |
| 3/8" NPT                | 3/16" | 1.625" | 0.562" | 7/8"  | P187-6FN |

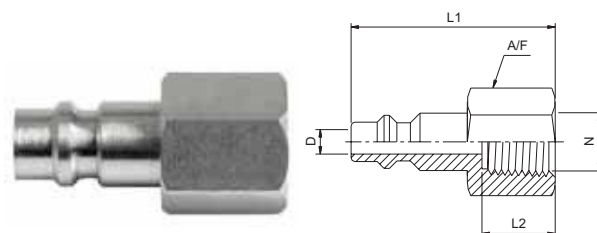

#### Male Barb End Plug

| P-Barb<br>End | D     | L1     | L2     | A/F   | PART NO. |
|---------------|-------|--------|--------|-------|----------|
| 1/4"          | 3/16" | 2.000" | 0.875" | 9/16" | P187-4BC |
| 5/16"         | 3/16" | 2.000" | 0.875" | 9/16" | P187-5BC |
| 3/8"          | 3/16" | 2.000" | 0.875" | 9/16" | P187-6BC |

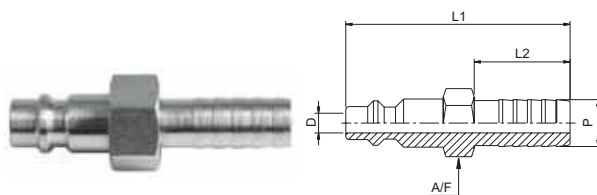

## SERIES P281 PLUGS

### Flow Passage 9/32"



#### Male NPT pipe thread

| N-Male<br>Pipe Thread | D     | L1     | L2     | A/F    | PART NO. |
|-----------------------|-------|--------|--------|--------|----------|
| 1/4" NPT              | 9/32" | 1.812" | 0.500" | 11/16" | P281-4N  |
| 3/8" NPT              | 9/32" | 1.812" | 0.500" | 11/16" | P281-6N  |
| 1/2" NPT              | 9/32" | 2.187" | 0.500" | 7/8"   | P281-8N  |

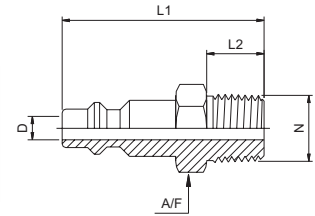

#### Female NPT pipe thread

| N-Female<br>Pipe Thread | D     | L1     | L2     | A/F     | PART NO. |
|-------------------------|-------|--------|--------|---------|----------|
| 1/4" NPT                | 9/32" | 1.750" | 0.562" | 3/4"    | P281-4FN |
| 3/8" NPT                | 9/32" | 1.750" | 0.562" | 7/8"    | P281-6FN |
| 1/2" NPT                | 9/32" | 1.937" | 0.750" | 1-1/16" | P281-8FN |

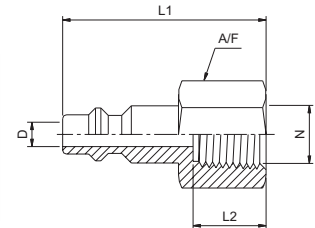

#### Male Barb End Plug

| P-Barb<br>End | D     | L1     | L2     | A/F  | PART NO. |
|---------------|-------|--------|--------|------|----------|
| 3/8"          | 9/32" | 2.312" | 1.000" | 5/8" | P281-6BC |
| 1/2"          | 9/32" | 2.500" | 1.187" | 5/8" | P281-8BC |

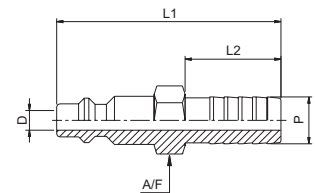

Dimensions are for reference only, and are subject to change without notice.

## SERIES P375 PLUGS

### Flow Passage 3/8"



#### Male NPT pipe thread

| N-Male<br>Pipe Thread | D    | L1     | L2     | A/F  | PART NO. |
|-----------------------|------|--------|--------|------|----------|
| 3/8" NPT              | 3/8" | 2.125" | 0.500" | 3/4" | P375-6N  |
| 1/2" NPT              | 3/8" | 2.375" | 0.685" | 7/8" | P375-8N  |

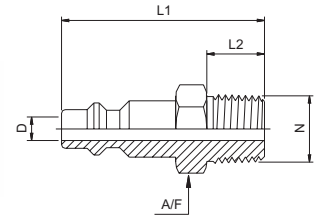

#### Female NPT pipe thread

| N-Female<br>Pipe Thread | D    | L1     | L2     | A/F     | PART NO. |
|-------------------------|------|--------|--------|---------|----------|
| 3/8" NPT                | 3/8" | 2.062" | 0.562" | 7/8"    | P375-6FN |
| 1/2" NPT                | 3/8" | 2.250" | 0.750" | 1-1/16" | P375-8FN |

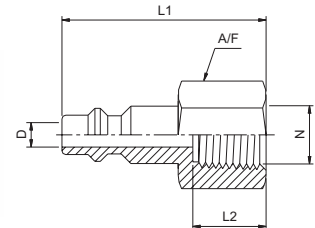

#### Male Barb End Plug

| P-Barb<br>End | D    | L1     | L2     | A/F  | PART NO.  |
|---------------|------|--------|--------|------|-----------|
| 1/2"          | 3/8" | 2.750" | 1.125" | 3/4" | P375-8BC  |
| 9/16"         | 3/8" | 2.750" | 1.125" | 3/4" | P375-9BC  |
| 5/8"          | 3/8" | 2.875" | 1.375" | 3/4" | P375-10BC |

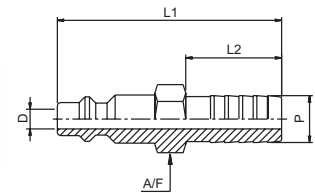

## SERIES P562 PLUGS

### Flow Passage 9/16"



#### Male NPT pipe thread

| N-Male<br>Pipe Thread | D     | L1     | L2     | A/F    | PART NO. |
|-----------------------|-------|--------|--------|--------|----------|
| 1/2" NPT              | 9/16" | 2.250" | 0.687" | 1"     | P562-8N  |
| 3/4" NPT              | 9/16" | 2.250" | 0.687" | 1-1/8" | P562-12N |

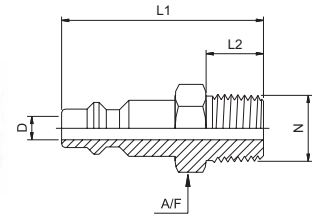

#### Female NPT pipe thread

| N-Female<br>Pipe Thread | D     | L1     | L2     | A/F     | PART NO.  |
|-------------------------|-------|--------|--------|---------|-----------|
| 3/8" NPT                | 9/16" | 1.937" | 0.562" | 1"      | P562-6FN  |
| 1/2" NPT                | 9/16" | 2.125" | 0.750" | 1-1/16" | P562-8FN  |
| 3/4" NPT                | 9/16" | 2.125" | 0.750" | 1-1/4"  | P562-12FN |

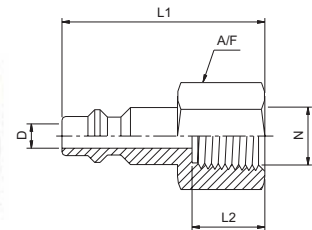

#### Male Barb End Plug

| P-Barb<br>End | D     | L1    | L2     | A/F | PART NO.  |
|---------------|-------|-------|--------|-----|-----------|
| 5/8"          | 9/16" | 3.00" | 1.375" | 1"  | P562-10BC |

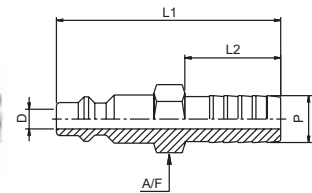

Dimensions are for reference only, and are subject to change without notice.







[www.sealexcel.com](http://www.sealexcel.com)



SEALEXCEL® (INDIA) PVT. LTD.

Registered office & Unit I :  
56 & 61, Veena Dalvai Industrial Estate, S.V. Road,  
Oshiwara, Jogeshwari (West), Mumbai - 400 102. INDIA  
Ph.: (+91-22) 2678 6885, 2678 8534, 6694 4124  
Fax : (+91-22) 2678 1426, 6694 4126  
E-mail : sales@sealexcel.com

Unit II :  
Plot no. 300/1 & 2, at Post - Mahi, Via Chhapi,  
Pirojpur - Mahi Road, Taluka - Vadgam,  
Dist - Banaskantha, North - Gujarat,  
Pin - 385 210. INDIA

Catalogue No. 06-02/QC